

**CITY OF CHARLESTON
KANAHWA COUNTY, WEST VIRGINIA**

CHARLESTON FIRE DEPARTMENT STATION #'S 1, 2, 4, 5 AND 8 RENOVATIONS

ADDENDUM #2

JUNE 25, 2025

THRASHER PROJECT #T60-11407

TO WHOM IT MAY CONCERN:

The following are clarifications and responses to questions posed by contractors for the above reference project.

A. GENERAL

1. THE BID DUE DATE HAS BEEN EXTENDED TO 2:00 PM, JULY 22, 2025.
2. The Owner will remove furniture, wall mounted TV's, radio boxes, equipment, detergent dispensing systems in spaces to be renovated.
3. Painted wall graphics identifying the station or company are to be painted over.
4. The maps painted on the wall at Station 5 are to remain.

B. SPECIFICATIONS

ADD: Section 105103 – GEAR LOCKER

ADD: Section 083613 – SECTIONAL DOOR

ADD: Section 101423.16 – ROOM IDENTIFICATION PANEL SIGNAGE

ADD: Section 102600 – WALL AND DOOR PROTECTION

C. DRAWINGS

ADD: Drawing ADD 2-1 - NEW DOOR INTO EXISTING GENERATOR ROOM

ADD: Drawing ADD 2-2 - NEW DOOR INTO EXISTING GENERATOR ROOM

D. QUESTIONS AND RESPONSES

1. QUESTION

Will ASSA ABLOY Sargent be considered as an acceptable substitution for the specified door hardware manufacturers?

RESPONSE

Yes, ASSA ABLOY is an acceptable substitution.

2. QUESTION

Were core cuts taken of the existing flat roof areas on stations 1 and 2?

RESPONSE

No. Roof assembly descriptions in the drawings are based on the original construction drawings.

3. QUESTION

Are the roof decks on station 1 and 8 structurally sloped or structurally flat?

RESPONSE

The roof deck on station 1 is structurally flat and station 8 is structurally sloped.

4. QUESTION

Specification Section 113013 Residential Appliances, Paragraph 2.4 references RF 1. Keyed Notes on Drawings for Fire Stations #1, #2, #4, #5 note Refrigerators are "N.I.C." Please clarify.

RESPONSE

Refrigerators are Not in Contract.

5. QUESTION

6/A4.02 & A7.01 – Please provide specifications for Markerboards and Tackboards.

RESPONSE

Markerboards are to be standard gloss white 28 gauge porcelain steel with aluminum frame without full length accessory tray, sized to the dimensions shown on the drawings. Provide 12 inch magnetic accessory tray. Tack boards are to be woven polypropylene fabric permanently adhered to 1/2 inch thick tackable cork or similar substrate with aluminum frame. Boards are to be sized to the dimensions shown on the drawings.

6. QUESTION

3/A7.01 - Please provide specifications for Wall Protection.

RESPONSE

Section 102600 attached to this addendum.

7. QUESTION

Please provide specifications for the overhead door.

RESPONSE

Section 083613 attached to this addendum.

8. QUESTION

Fire Station #1: A7.01 – Please provide specifications for Signage.

RESPONSE

Section 101423.16 attached to this addendum.

9. QUESTION

Fire Station #1: Door Schedule: Please confirm door material and door finishes. (H.M. are to be stained).

RESPONSE

H.M. Doors are to be Painted.

10. QUESTION

Fire Station #1: Please provide Door Hardware Group No. 11 for door 220B.

RESPONSE

Provide the same Hardware Group No. 11 as listed on Station #4 A6.01.

11. QUESTION

Fire Station #1: 5/A4.01 – Please clarify if stacked laundry items are N.I.C. or to be the items in Specification Section 113013, Paragraph 2.6 Clothes Washers and Dryer.

RESPONSE

Stackable laundry items are to be in the contract. Washer and Dryer described in Section 113013, Paragraph 2.6 are front loading, Stackable units. A single unit, stacked laundry center is not required.

12. QUESTION

Fire Station #2: A4.01 - Kitchen Equipment Schedule, Keyed Note 10 “24” Apartment Size Electric Range”. Specifications “Gas Range 2” which is 24”. Please clarify if range to be provided is electric or gas. If electric, please provide specifications for this item.

RESPONSE

Range #2 is to be a 24 inch Freestanding stainless steel, four coil burners, Electric Range with conventional oven having two racks – four positions. Acceptable manufacturers: Frigidaire, GE, Hotpoint, Summit Appliance, Whirlpool. Modify existing 220V power to location as shown on 1/A4.01.

13. QUESTION

Fire Station #2: A4.01 – Please confirm Kitchen Base Cabinet Height of 36” (ex. SB2736).

RESPONSE

Countertop work surface should be 34 inches A.F.F. as required by 2017 ICC A117.1 Accessible and Usable Buildings.

14. QUESTION

Fire Station #2: A6.01 Door Schedule. Please confirm Doors 226, 228A and 229 are ETR. Schedule notes as Type “F”.

RESPONSE

Doors 226, 228A, 229 are Existing To Remain (ETR). Paint as scheduled.

15. QUESTION

Fire Station #2: Please provide Door Hardware Group No. 11 for door 228B.

RESPONSE

Provide the same Hardware Group No. 11 as listed on Station #4 A6.01.

16. QUESTION

Fire Station #2: 11/A4.02 – Please clarify if stacked laundry items are N.I.C. or to be provided and installed by Contractor. Washer and Dryer are listed items in Specification Section 113013, Paragraph 2.6 Clothes Washers and Dryer.

RESPONSE

Washer and Dryer described in Section 113013, Paragraph 2.6 are front loading, Stackable units. A single unit stacked laundry center is not required

17. QUESTION

Fire Station #4: During the pre-bid, it was mentioned that sanitary work at Station #4 was being completed outside of this contract. Please confirm the scope of that work and advise if any of the revised sanitary routing shown on C1.01 should be included in this project.

RESPONSE

The Charleston Sanitary Board will be rerouting the main sanitary line with manholes as shown on C1.01 (Medium Green Lines). The Contractor will be responsible for the extension of the building storm and sanitary lines (Dark Green Lines) and connection to the main sanitary line.

18. QUESTION

Fire Station #4: A1.01 – Please clarify if Firematic Equipment items are in contact or by Owner. If in contract, please provide specifications.

RESPONSE

Provide 30 LB hard mounted washer-extractor, UniMac UCT030 or equal. Provide PPE drying cabinet, UniMac UTGC or equal.

19. QUESTION

Fire Station #4: 1/A3.03 indicates an “Adhered weather Barrier” at the cavity face of new block. Can Prosoco Spray Wrap MVP be used for this application?

RESPONSE

Prosoco Spray Wrap MVP is acceptable.

20. QUESTION

Fire Station #5: A4.03 – Please provide specifications for the Gear Lockers in Turnout 102.

RESPONSE

Section 105103 attached to this addendum.

21. QUESTION

Fire Station #5: A4.03 – Please clarify if Firematic Equipment items are in contact or by Owner. If in contract, please provide specifications.

RESPONSE

Provide 30 LB hard mounted washer-extractor, UniMac UCT030 or equal. Provide PPE drying cabinet, UniMac UTGC or equal.

22. QUESTION

Due to the number of buildings in the project, and the July 4th holiday in the middle, is it possible to extend the bid opening date?

RESPONSE

Yes, the bid opening date will be extended to 2:00 p.m., Tuesday, July 22, 2025.

E. CLARIFICATIONS

1. Construction phasing for the project is to work within the following conditions:
 - a. Station 1 and Station 5 are to be Phase One of the work and may occur simultaneously. Station 1 should be given priority within this first phase.
 - b. Station 1 will remain partially operational with one engine company working from the first floor. There will be no occupancy of the second floor.
 - c. Once Station 1 is completed, work can move to Phase Two.
 - d. Station 2 and Station 4 are to be Phase Two of the Work. American Water has recently disclosed plans for water system maintenance that will impact Station 4.
 - e. Station 4 cannot close during the water system maintenance project and should be planned to be the last station offline.
 - f. Station 8 is a roof replacement and exterior wall coating and should not interrupt operations. It may be completed within either Phase One or Phase Two as best fits the Contractor's schedule.
2. Upon award of the project, if the Contractor determines the need for additional lay down area at Station 5 the Contractor will need to submit an application and traffic control plan to the City of Charleston for request to partially close Walnut Rd adjacent to the Station.

Bidder questions should be submitted in writing to Philip Freeman and Makenzie Workman at the following email addresses:

pfreeman@thethrashergruop.com and mworkman@thethrashergruop.com

The deadline for final questions is Tuesday July 15, 12:00 pm. Questions received after this time may not receive a response.

As a reminder, bids will be received until 2:00 p.m. on Tuesday, July 22, 2025, at Charleston City Hall, Room 101, 501 Virginia St E, Charleston, WV. Good luck to everyone and thank you for your interest in the project.

Sincerely,

THE THRASHER GROUP, INC.

Philip M Freeman, AIA, NCARB
Project Architect



SECTION 083613 - SECTIONAL DOORS

PART 1 - GENERAL

1.1 SUMMARY

- A. Electrically operated sectional doors.

1.2 ACTION SUBMITTALS

- A. Product Data: For each type and size of sectional door and accessory.
- B. Samples: For each exposed product and for each color and texture specified.

1.3 INFORMATIONAL SUBMITTALS

- A. Sample warranty.

1.4 CLOSEOUT SUBMITTALS

- A. Maintenance data.

1.5 QUALITY ASSURANCE

- A. Installer Qualifications: An entity that employs installers and supervisors who are trained and approved by manufacturer for both installation and maintenance of units required for this Project.

1.6 WARRANTY

- A. Special Warranty: Manufacturer agrees to repair or replace components of sectional doors that fail in materials or workmanship within specified warranty period.
 - 1. Warranty Period: Two years from date of Substantial Completion.
- B. Special Finish Warranty: Manufacturer agrees to repair or replace components that show evidence of deterioration of factory-applied finishes within specified warranty period.
 - 1. Warranty Period: 5 years from date of Substantial Completion.

PART 2 - PRODUCTS

2.1 PERFORMANCE REQUIREMENTS

- A. General Performance: Sectional doors shall comply with performance requirements specified without failure due to defective manufacture, fabrication, installation, or other defects in construction and without requiring temporary installation of reinforcing components.

2.2 DOOR ASSEMBLY

- A. Steel Sectional Door: Sectional door formed with hinged sections and fabricated according to DASMA 102 unless otherwise indicated.
 - 1. Manufacturers: Subject to compliance with requirements, provide products by one of the following:
 - a. Arm-R-Lite.
 - b. Clopay Building Products.
 - c. Overhead Door Corporation.
 - d. Raynor.
 - e. Wayne-Dalton Corp.
- B. Operation Cycles: Door components and operators capable of operating for not less than 30,000.
- C. Air Infiltration: Maximum rate of 0.4 cfm/sq. ft. at 15 and 25 mph when tested according to ASTM E283 or DASMA 105.
- D. R-Value: 12.0 deg F x h x sq. ft./Btu.
- E. Steel Sections: Zinc-coated (galvanized) steel sheet with G60 zinc coating.
 - 1. Section Thickness: 2 inches.
 - 2. Exterior-Face Surface: Raised Panel
 - 3. Interior Facing Material: Zinc-coated (galvanized) steel sheet.
- F. Track Configuration: Low clearance-lift track.
- G. Weatherseals: Fitted to bottom and top and around entire perimeter of door. Provide combination bottom weatherseal and sensor edge.
- H. Electric Door Operator:
 - 1. Usage Classification: Medium duty, 12 or more cycles per hour and more than 50 cycles per day.
 - 2. Operator Type: 1/2 Horsepower, Chain Drive.

3. Safety: Listed according to UL 325 by a qualified testing agency for residential or commercial use; moving parts of operator enclosed or guarded if exposed and mounted at 8 feet or lower.
4. Motor Exposure: Interior, clean, and dry.
5. Emergency Manual Operation: Chain type.
6. Obstruction-Detection Device: Automatic photoelectric sensor.
7. Control Station: Interior face of door jamb
8. Other Equipment: Portable, radio-control system.

I. Door Finish:

1. Baked-Enamel or Powder-Coat Finish: Color and gloss as selected by Architect from manufacturer's full range.
2. Finish of Interior Facing Material: Match finish of exterior section face.

2.3 STEEL DOOR SECTIONS

- A. Exterior Section Faces and Frames: Zinc-coated (galvanized), cold-rolled, commercial steel (CS) sheet.
1. Roll horizontal meeting edges to a continuous, interlocking, keyed, rabbeted, shiplap, or tongue-in-groove weather-resistant seal, with a reinforcing flange return.
 2. For insulated doors, provide sections with continuous thermal-break construction, separating the exterior and interior faces of door.
- B. Section Ends and Intermediate Stiles: Enclose open ends of sections with channel end stiles formed from galvanized-steel sheet welded to door section. Provide intermediate stiles formed from galvanized-steel sheet, cut to door section profile, and welded in place. Space stiles not more than 48 inches apart.
- C. Reinforce bottom section with a continuous channel or angle conforming to bottom-section profile and allowing installation of astragal.
- D. Provide reinforcement for hardware attachment.
- E. Thermal Insulation: Insulate interior of steel sections with door manufacturer's standard CFC-free insulation, with maximum flame-spread and smoke-developed indexes of 75 and 450, respectively, according to ASTM E84. Enclose insulation completely within steel sections and the interior facing material, with no exposed insulation.

2.4 TRACKS, SUPPORTS, AND ACCESSORIES

- A. Tracks: Manufacturer's standard, galvanized-steel track system of configuration indicated, sized for door size and weight, designed for lift type indicated and clearances indicated on Drawings. Provide complete system including brackets, bracing, and reinforcement to ensure rigid support of ball-bearing roller guides for required door type, size, weight, and loading.

1. Track Reinforcement and Supports: Galvanized-steel members to support track without sag, sway, and vibration during opening and closing of doors. Slot vertical sections of track spaced 2 inches apart for door-drop safety device.
- B. Weatherseals: Replaceable, adjustable, continuous, compressible weather-stripping gaskets of flexible vinyl, rubber, or neoprene fitted to bottom and top of sectional door unless otherwise indicated.

2.5 HARDWARE

- A. General: Standard-duty, corrosion-resistant hardware, with hot-dip galvanized, stainless-steel, or other corrosion-resistant fasteners, to suit door type.
- B. Hinges: Standard-duty, galvanized-steel hinges at each end stile and at each intermediate stile, according to manufacturer's written recommendations for door size. Attach hinges to door sections through stiles and rails.
- C. Rollers: Standard-duty rollers with steel ball-bearings in case-hardened steel races, mounted with varying projections to suit slope of track. Provide 3-inch-diameter roller tires for 3-inch-wide track and 2-inch-diameter roller tires for 2-inch-wide track.

2.6 COUNTERBALANCE MECHANISM

- A. Torsion Spring: Counterbalance mechanism consisting of adjustable-tension torsion springs fabricated from steel-spring wire complying with ASTM A229/A229M, mounted on torsion shaft made of steel tube or solid steel. Provide springs designed for number of operation cycles indicated.
- B. Cable Drums and Shaft for Doors: Cast-aluminum or gray-iron casting cable drums mounted on torsion shaft and grooved to receive door-lifting cables as door is raised. Mount counterbalance mechanism with manufacturer's standard ball-bearing brackets at each end of torsion shaft.
- C. Cables: Galvanized-steel, multistrand, lifting cables.
- D. Cable Safety Device: Include a spring-loaded steel or spring-loaded bronze cam mounted to bottom door roller assembly on each side and designed to automatically stop door if either lifting cable breaks.
- E. Bracket: Provide anchor support bracket as required to connect stationary end of spring to the wall and to level the shaft and prevent sag.
- F. Bumper: Provide spring bumper at each horizontal track to cushion door at end of opening operation.

2.7 ELECTRIC DOOR OPERATORS

- A. General: Electric door operator assembly of size and capacity recommended and provided by door manufacturer for door and "operation cycles" requirement specified, with electric motor and factory-prewired motor controls, starter, gear-reduction unit, solenoid-operated brake, clutch, control stations, control devices, integral gearing for locking door, and accessories required for proper operation.
 - 1. Manufacturers: Subject to compliance with requirements, available manufacturers offering products that may be incorporated into the Work include, but are not limited to the following:
 - a. Chamberlain Group, Inc. (The).
 - 2. Comply with NFPA 70.
 - 3. Control equipment complying with NEMA ICS 1, NEMA ICS 2, and NEMA ICS 6; with NFPA 70, Class 2 control circuit, maximum 24-V ac or dc.
- B. Usage Classification: Electric operator and components capable of operating for not less than number of cycles per hour indicated for each door.
- C. Door-Operator Type: Unit consisting of electric motor, gears, pulleys, belts, sprockets, chains, and controls needed to operate door and meet required usage classification.
- D. Motors: Reversible-type motor with controller (disconnect switch) for motor exposure indicated.
 - 1. Electrical Characteristics:
 - a. Phase: Polyphase.
 - b. Volts: 120 V.
 - c. Hertz: 60.
 - 2. Motor Size: 1/2 HP, Minimum size. Size motor large enough to start, accelerate, and operate door in either direction from any position, at a speed of 11 in./sec. to 12 in./sec., without exceeding nameplate ratings or service factor.
- E. Obstruction Detection Device: External entrapment protection consisting of indicated automatic safety sensor capable of protecting full width of door opening. Activation of device immediately stops and reverses downward door travel.
 - 1. Photoelectric Sensor: Manufacturer's standard system designed to detect an obstruction in door opening without contact between door and obstruction.
 - a. Self-Monitoring Type: Designed to interface with door operator control circuit to detect damage to or disconnection of sensing device. When self-monitoring feature is activated, door closes only with sustained pressure on close button.
- F. Control Station: One-button control station in fixed location with momentary-contact push-button control.

1. Interior-Mounted Units: Full-guarded, surface-mounted with general-purpose NEMA ICS 6, Type 1 enclosure.
- G. Emergency Manual Operation: Equip electrically powered door with capability for emergency manual operation. Design manual mechanism so required force for door operation does not exceed 25 lbf.
- H. Emergency Operation Disconnect Device: Equip operator with hand-operated disconnect mechanism for automatically engaging manual operator and releasing brake for emergency manual operation while disconnecting motor without affecting timing of limit switch. Mount mechanism so it is accessible from floor level. Include interlock device to automatically prevent motor from operating when emergency operator is engaged.
- I. Motor Removal: Design operator so motor may be removed without disturbing limit-switch adjustment and without affecting emergency manual operation.
- J. Portable, Radio-Control System: Consisting of two of the following:
 1. Three-channel universal coaxial receiver to open, close, and stop door.

PART 3 - EXECUTION

3.1 INSTALLATION

- A. Install sectional doors and operating equipment complete with necessary hardware, anchors, inserts, hangers, and equipment supports; according to manufacturer's written instructions and as specified.
- B. Tracks: Provide sway bracing, diagonal bracing, and reinforcement as required for rigid installation of track and door-operating equipment.
- C. Accessibility: Install sectional doors, switches, and controls along accessible routes in compliance with regulatory requirements for accessibility.
- D. Power-Operated Doors: Install automatic garage doors openers according to UL 325.
- E. Adjust hardware and moving parts to function smoothly so that doors operate easily, free of warp, twist, or distortion.
- F. Touch-up Painting: Immediately after welding galvanized materials, clean welds and abraded galvanized surfaces and repair galvanizing to comply with ASTM A780/A780M.

END OF SECTION 083613

SECTION 101423.16 - ROOM-IDENTIFICATION PANEL SIGNAGE

PART 1 - GENERAL

1.1 SUMMARY

- A. Section includes room-identification signs that are directly attached to the building.

1.2 ACTION SUBMITTALS

- A. Product Data: For each type of product.
- B. Shop Drawings: For room-identification signs.
 - 1. Include installation details and attachments to other work.
 - 2. Show sign mounting heights and locations.
 - 3. Show typestyles, graphic elements, including raised characters and Braille, and layout for each sign.
- C. Samples: For each exposed product and for each color and texture specified.

1.3 INFORMATIONAL SUBMITTALS

- A. Sample warranty.

1.4 CLOSEOUT SUBMITTALS

- A. Maintenance data.

1.5 WARRANTY

- A. Special Warranty: Manufacturer agrees to repair or replace components of signs that fail in materials or workmanship within specified warranty period.
 - 1. Warranty Period: Five years from date of Substantial Completion.

PART 2 - PRODUCTS

2.1 PERFORMANCE REQUIREMENTS

- A. Accessibility Standard: Comply with applicable provisions in the USDOJ's "2010 ADA Standards for Accessible Design" the ABA standards of the Federal agency having jurisdiction and ICC A117.1.

2.2 ROOM-IDENTIFICATION SIGNS

- A. Room-Identification Sign: Sign with smooth, uniform surfaces; with message and characters having uniform faces, sharp corners, and precisely formed lines and profiles; and as follows:
 - 1. Manufacturers: Subject to compliance with requirements, available manufacturers offering products that may be incorporated into the Work include, but are not limited to the following:
 - a. Best Sign Systems, Inc.
 - b. Inpro Corporation.
 - c. Mohawk Sign Systems.
 - 2. Laminated-Sheet Sign: Sandblasted or engraved polymer face sheet with raised graphics laminated to backing sheet to produce composite sheet.
 - a. Composite-Sheet Thickness: Manufacturer's standard for size of sign.
 - b. Characters: Tactile - Raised
 - c. Color(s): As selected by Architect from manufacturer's full range.
 - 3. Sign-Panel Perimeter: Finish edges smooth.
 - a. Edge Condition: Square cut - unframed.
 - b. Corner Condition in Elevation: Rounded.
 - 4. Mounting: Manufacturer's standard method for substrates indicated with two-face tape.

2.3 ACCESSORIES

- A. Two-Face Tape: Manufacturer's standard high-bond, foam-core tape, 0.045 inch thick, with adhesive on both sides.

PART 3 - EXECUTION

3.1 INSTALLATION

- A. General: Install signs using mounting methods indicated and according to manufacturer's written instructions.
 - 1. Install signs level, plumb, true to line, and at locations and heights indicated, with sign surfaces free of distortion and other defects in appearance.
 - 2. Install signs so they do not protrude or obstruct according to the accessibility standard.
 - 3. Before installation, verify that sign surfaces are clean and free of materials or debris that would impair installation.
- B. Mounting Methods:
 - 1. Two-Face Tape: Clean bond-breaking materials from substrate surface and remove loose debris. Apply tape strips symmetrically to back of sign and of suitable quantity to support weight of sign without slippage. Keep strips away from edges to prevent visibility at sign edges. Place sign in position, and push to engage tape adhesive.

END OF SECTION 101423.16

City of Charleston
Charleston Fire Department Station #'s 1, 2, 4, 5 and 8 Renovations

Added per Addendum #2
June 25, 2025
T60-11407

This page intentionally left blank.

SECTION 102600 - WALL AND DOOR PROTECTION

PART 1 - GENERAL

1.1 SUMMARY

- A. Section Includes:
 - 1. Corner guards.

1.2 ACTION SUBMITTALS

- A. Product Data: For each type of product.
- B. Shop Drawings: For each type of wall protection showing locations and extent.
- C. Samples: For each exposed product and for each color and texture specified, 6 inches long.

1.3 INFORMATIONAL SUBMITTALS

- A. Product certificates.
- B. Sample warranty.

1.4 CLOSEOUT SUBMITTALS

- A. Maintenance data.

1.5 WARRANTY

- A. Special Warranty: Manufacturer agrees to repair or replace components of wall- and door-protection units that fail in materials or workmanship within specified warranty period.
 - 1. Warranty Period: Ten years from date of Substantial Completion.

PART 2 - PRODUCTS

2.1 PERFORMANCE REQUIREMENTS

- A. Surface Burning Characteristics: Comply with ASTM E84 or UL 723; testing by a qualified testing agency. Identify products with appropriate markings of applicable testing agency.
 - 1. Flame-Spread Index: 25 or less.

2. Smoke-Developed Index: 450 or less.

- B. Regulatory Requirements: Comply with applicable provisions in the U.S. Architectural & Transportation Barriers Compliance Board's ADA-ABA Accessibility Guidelines for Buildings and Facilities and ICC A117.1.

2.2 WALL GUARDS

2.3 CORNER GUARDS

- A. Surface-Mounted, Opaque-Plastic Corner Guards: Fabricated as one piece from PVC plastic; with formed edges; fabricated with 90- or 135-degree turn to match wall condition.

1. Manufacturers: Subject to compliance with requirements, provide products by one of the following:

- a. Babcock-Davis.
- b. JL Industries; Activar Construction Products Group, Inc.
- c. WallGuard.com.
- d. Wallprotex.
- e. inpro Corporation.

2. Mounting: Adhesive.

3. Color and Texture: As selected by Architect from manufacturer's full range.

2.4 MATERIALS

- A. Plastic Materials: Chemical- and stain-resistant, high-impact-resistant plastic with integral color throughout; extruded and sheet material as required, thickness as indicated.

- B. Adhesive: As recommended by protection product manufacturer.

PART 3 - EXECUTION

3.1 INSTALLATION

- A. Installation Quality: Install wall and door protection according to manufacturer's written instructions, level, plumb, and true to line without distortions. Do not use materials with chips, cracks, voids, stains, or other defects that might be visible in the finished Work.

- B. Mounting Heights: Install wall and door protection in locations and at mounting heights indicated on Drawings.

END OF SECTION 102600

SECTION 105103 - GEAR LOCKERS

PART 1 - GENERAL

1.1 SUMMARY

- A. Section Includes:
 - 1. Wall mounted turnout gear lockers.

1.2 ACTION SUBMITTALS

- A. Product Data: For each type of product.
- B. Shop Drawings:
 - 1. Include plans, elevations, sections, and attachment details.
- C. Samples: For each color specified.

1.3 INFORMATIONAL SUBMITTALS

- A. Sample warranty.

1.4 CLOSEOUT SUBMITTALS

- A. Maintenance data.

1.5 WARRANTY

- A. Warranty: Manufacturer's standard warranty.

PART 2 - PRODUCTS

2.1 TURNOUT GEAR LOCKER

- A. Basis of Design Product
 - 1. Gloves Incorporated
 - a. Ready Rack
 - 1) Wall Mounted Red Rack
- B. Manufacturers: Subject to compliance with requirements, provide products by one of the following:

1. GearGrid Corporation.
 2. Gloves Incorporated – Ready Rack
- C. Product Description: Wall mounted storage locker, welded tubular steel construction.
1. Width: 24 inches
 2. Depth: 24 inches
 3. Height: 72 inches
- D. Construction:
1. Outer Frames: 1.25 inch, 16 gauge ASTM A513 steel tubing.
 2. Grid: 0.25 inch diameter ASTM 510 cold drawn steel wire welded to a 3 inch square pattern.
 - a. Grid wires must be full length and width of inside frame.
 - b. Grid wires shall intersect and cross all perpendicular wires, and shall be welded at all intersections.
 3. Back Panels: Required on each locker to protect the locker contents and wall substrate.
 4. Adjustable Shelves: (1) Upper, (1) Lower. .25" diameter ASTM 510 cold drawn steel wire resistance welded and cold formed. Upper shelf shall include an integrated 20 gauge steel bracket to accept a 2" x 16" name placard.
 5. Apparel Hooks: (2) per locker opening. .192" diameter ASTM 510 cold drawn steel wire resistance welded, cold formed and powder coated. Apparel hooks must securely engage and snap onto side or back grid, to prevent unintentional disengagement of hook.
 6. Hang Bar: Adjustable height, length of unit.
 - a. Tube: 1.25 inch O.D. x 16 gauge 304 stainless steel tubing.
 - b. Brackets: Allow hang bars to be securely attached at each vertical divider.
- E. Finish: Powder coat.
1. Color: As selected by Architect from manufacturer's full range.

PART 3 - EXECUTION

3.1 INSTALLATION

- A. Install lockers level, plumb, and true.
- B. Install lockers in accordance with manufacturer's instructions.
- C. Use manufacturer's hardware for assembly.
- D. Anchor to mounting surface with manufacturer's recommended hardware.

END OF SECTION 105103

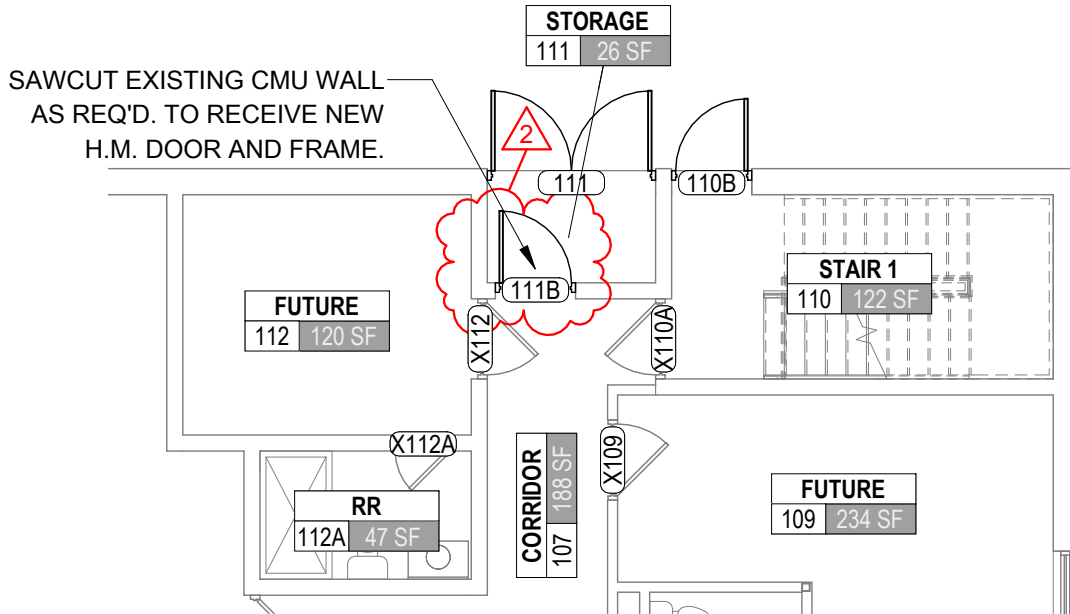

1 ADD #2 - DOOR TO GENERATOR ROOM 111
ADD 2-1 1/8" = 1'-0"

ADD #2 DOOR, FRAME, & HARDWARE SCHEDULE

#	DOOR					FRAME			ASSEMBLY	
	DOOR TYPE	WIDTH	HEIGHT	DOOR MATERIAL	DOOR FINISH	FRAME TYPE	FRAME MATERIAL	FRAME FINISH	HARDWARE	KEYROOM
111B	F	3' - 0"	7' - 0"	H.M.	PAINT	2	H.M.	PAINT	25	107

HARDWARE GROUP NO. 25

PROVIDE EACH OPENING WITH THE FOLLOWING:

QTY		DESCRIPTION	CATALOG NUMBER	FINISH	MFR
3	EA	HINGE	5BB1 4.5 X 4.5 (NRP AS REQUIRED)	652	IVE
1	EA	ENTRANCE/OFFICE LOCK	ND50TD SPA	626	SCH
1	EA	FSIC CORE	23-030	626	SCH
1	EA	OH STOP	90S	630	GLY
1	EA	MOP PLATE	8400 4" X 1" LDW B-CS	630	IVE
1	EA	GASKETING	SR64/65 OR 488 SEALS AS REQUIRED	BK	ZER
HDWE SUPPLIER/GC TO VERIFY COMPATIBILITY WITH EXISTING DOOR/FRAME FOR NEW HDWE					

REVISION SCHEDULE

No.	DATE	DESCRIPTION
2	6/25/2025	NEW DOOR TO EXISTING GENERATOR ROOM.

THE INFORMATION CONTAINED HEREIN IS THE SOLE PROPERTY OF THE THRASHER GROUP, INC. REPRODUCTION OF THESE DOCUMENTS IN WHOLE OR IN PART FOR ANY REASON WITHOUT PRIOR WRITTEN PERMISSION IS STRICTLY PROHIBITED.
COPYRIGHT © 2025 THE THRASHER GROUP, INC.

THRASHER
THE THRASHER GROUP INC.

600 WHITE OAKS BOULEVARD, BRIDGEPORT, WV 26330
PHONE: (304)624-4108 FAX: (304)624-7831

NEW DOOR INTO EXISTING GENERATOR ROOM
CHARLESTON FD - STATION NO. 1

DRAWN: GMH CHECKED: PMF APPROVED: TTG ISSUED DATE: 06/25/25

ADDENDUM REFERENCE / NUMBER

ADD 2-1

PROJECT No. T60-11407

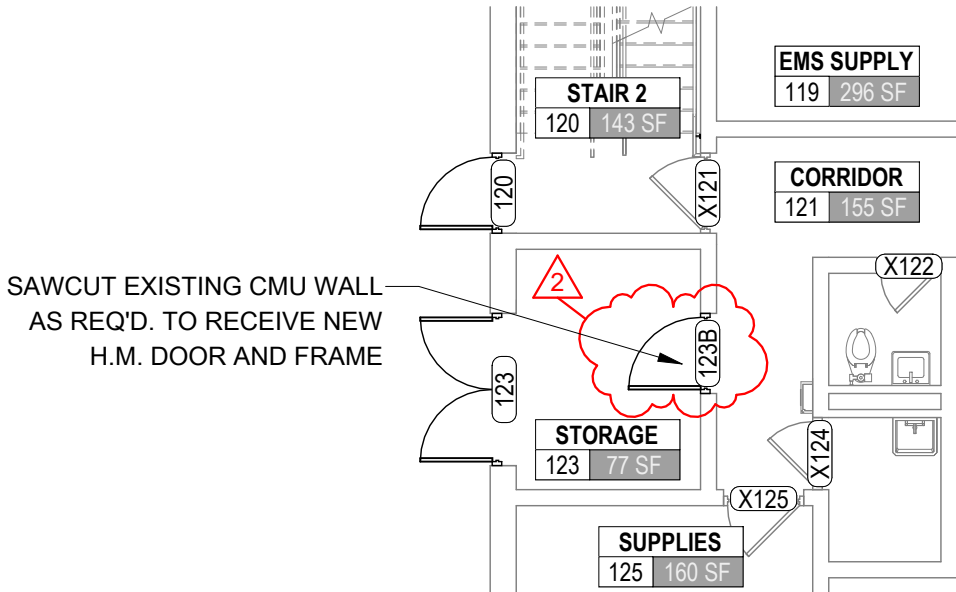

1 ADD #2 - DOOR TO GENERATOR ROOM 123
ADD 2-2 1/8" = 1'-0"

ADD #2 DOOR, FRAME, & HARDWARE SCHEDULE

#	DOOR					FRAME			HARDWARE	KEYROOM
	DOOR TYPE	WIDTH	HEIGHT	DOOR MATERIAL	DOOR FINISH	FRAME TYPE	FRAME MATERIAL	FRAME FINISH		
123B	F	3' - 0"	7' - 0"	H.M.	PAINT	2	H.M.	PAINT	25	121

HARDWARE GROUP NO. 25

PROVIDE EACH OPENING WITH THE FOLLOWING:

QTY		DESCRIPTION	CATALOG NUMBER	FINISH	MFR
3	EA	HINGE	5BB1 4.5 X 4.5 (NRP AS REQUIRED)	652	IVE
1	EA	ENTRANCE/OFFICE LOCK	ND50TD SPA	626	SCH
1	EA	FSIC CORE	23-030	626	SCH
1	EA	OH STOP	90S	630	GLY
1	EA	MOP PLATE	8400 4" X 1" LDW B-CS	630	IVE
1	EA	GASKETING	SR64/65 OR 488 SEALS AS REQUIRED	BK	ZER
HDWE SUPPLIER/GC TO VERIFY COMPATIBILITY WITH EXISTING DOOR/FRAME FOR NEW HDWE					

REVISION SCHEDULE		
No.	DATE	DESCRIPTION
2	6/25/2025	NEW DOOR TO EXISTING GENERATOR ROOM.

THE INFORMATION CONTAINED HEREIN IS THE SOLE PROPERTY OF THE THRASHER GROUP, INC. REPRODUCTION OF THESE DOCUMENTS IN WHOLE OR IN PART FOR ANY REASON WITHOUT PRIOR WRITTEN PERMISSION IS STRICTLY PROHIBITED.
COPYRIGHT © 2025 THE THRASHER GROUP, INC.

THRASHER
THE THRASHER GROUP INC.

600 WHITE OAKS BOULEVARD, BRIDGEPORT, WV 26330
PHONE: (304)624-4108 FAX: (304)624-7831

NEW DOOR INTO EXISTING GENERATOR ROOM
CHARLESTON FD - STATION NO. 2

DRAWN: GMH CHECKED: PMF APPROVED: TTG ISSUED DATE: 06/25/25

ADDENDUM REFERENCE / NUMBER

ADD 2-2

PROJECT No. T60-11407